

Parts List

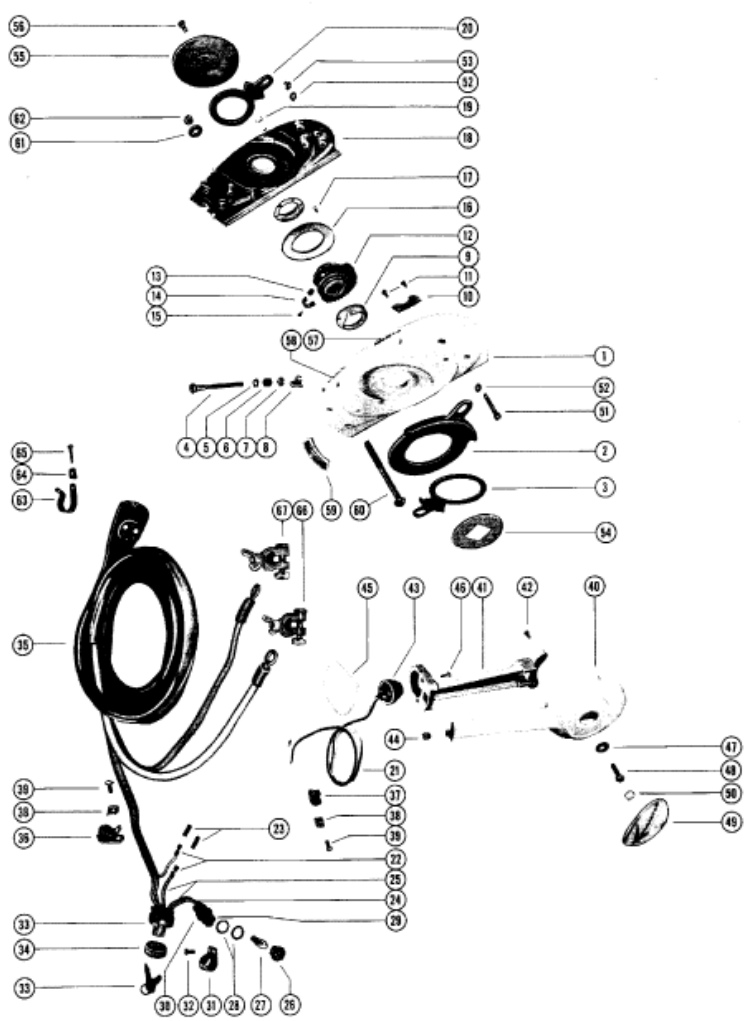

Ref	Class	Part	Description	Qty	Comment	Footnote
-		29699A10	ELECTRIC REMOTE CONTROL A	1		
-		29699A15	ELECTRIC REMOTE CONTROL A	1		
-		29699A20	ELECTRIC REMOTE CONTROL A	1		
1		29731	HOUSING, REMOTE CONTR	1		
2		29724	CAM, FORWARD START - CON	1		
3		29723	CAM, REVERSE START - CONT	1		
4	10	30489	SCREW, CAM ADJUSTMENT	3	SEE NOTES	30,16
5	13	29720	WASHER, WAVE - CAM ADJUS	3	SEE NOTES	30,16
6	23	30507	SLEEVE, CAM ADJUSTMENT SI	3	SEE NOTES	30,16
7	11	30506	NUT, UPPER - CAM ADJUSTME	3	SEE NOTES	30,16
8	11	29716	NUT, LOWER - CAM ADJUSTME	3		
9	23	29719	BUSHING, NYLON - GEAR SEC	2		
10		26667	PLATE, GEAR RACK RETAININ	1		
11	10	26668	SCREW, GEAR RACK RETAININ	2		
12	43	29728	GEAR, SECTOR	1		
13	23	30299	SLEEVE, CONTROL LEVER HAF	1		
14	54	29828	CLIP, CONTROL LEVER HARNE	1		
15	10	26381	SCREW, HARNESS CLIP TO GE	1		
16	12	29735	WASHER, HARNESS - GEAR SE	1		
17	10	29762	SCREW, HARNESS GUARD W/	2		
18		29732	HOUSING, REMOTE CONTROL	1		
19	19	29991	PLUG, CAM ADJUSTMENT SCR	1		
20		29829	STOP, FULL THROTTLE - CON	1		
21		29761	HARNESS, CONTROL LEVER T	1		
22		29879	CONNECTOR, BUTT - HARNES	2		
23	23	29902	SLEEVE, BUTT CONNECTOR C	2		
24		29752	JUMPER WIRE, IGNITION SWI	1		
25		26672	JUMPER WIRE, SWITCH TO PI	2		
26		27041	LENS, PILOT LIGHT	1		
27		27040	BULB, PILOT LIGHT	1		
28	27	27038	GASKET, PILOT LIGHT LENS	2		
29		27039	SOCKET, BAYONET - PILOT LI	1		
30	12	29805	WASHER, PILOT LIGHT BAYON	1		
31	54	27133	CLAMP, PILOT LIGHT TO CONT	1		
32	10	26668	SCREW, PILOT LIGHT CLAMP	1		
33S		29060	SWITCH, IGNITION (WITH KEY:	1		29
33S		30163	SWITCH, IGNITION (WITH KEY:	1		29
34		22628	BEZEL, IGNITION SWITCH TO	1		
35		29729 2	WIRING HARNESS, EXTERNAL	1		
35		29729 4	WIRING HARNESS, EXTERNAL	1		